



Derby City: Self-managed allotment sites

Ruth Bucknall



Derby City Council

Derby City: Self-managed urban allotment sites

- Introduction and overview of allotments in Derby
- Self-management model – benefits and risks
- Collaborative working and ongoing support for self-managed allotment sites



Derby allotments: Overview and history

- **19** under lease agreements
- **2** directly managed by local authority
- **8** privately owned sites
- **2200** plots (approximately)
- **1890 – 1915** Industrial growth led to creation of allotments
- **1950's post war** – Grow your own movement led to second wave of new sites
- **Last 10 years** – Increase in allotment demand led to regeneration of 2 disused sites and 2 new sites



Derby Allotments: Overview and history

1846 – 1901 County Series

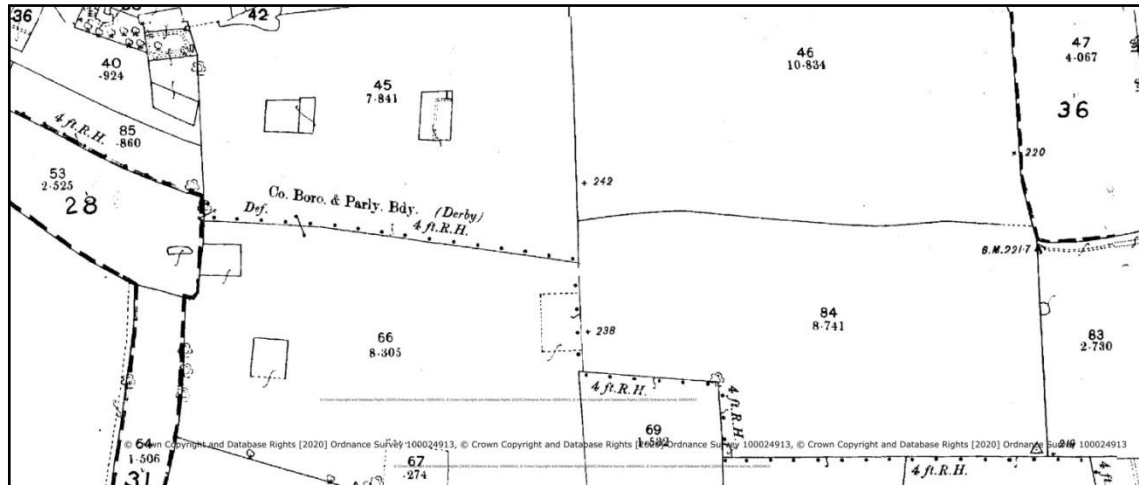

1888 – 1915 County Series

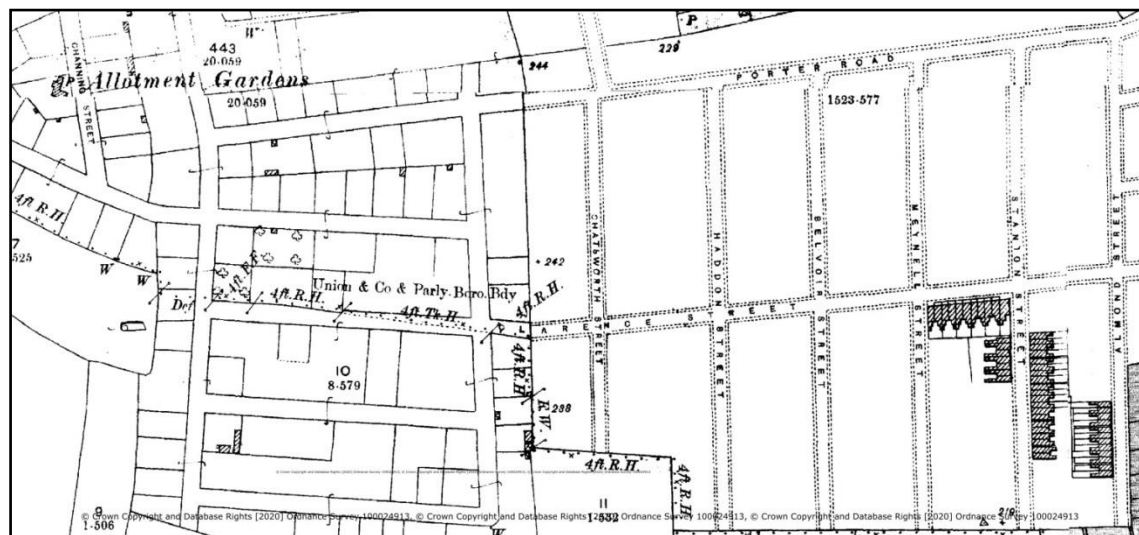

Derby Allotments: Overview and history

1950's 2.5k National Grid

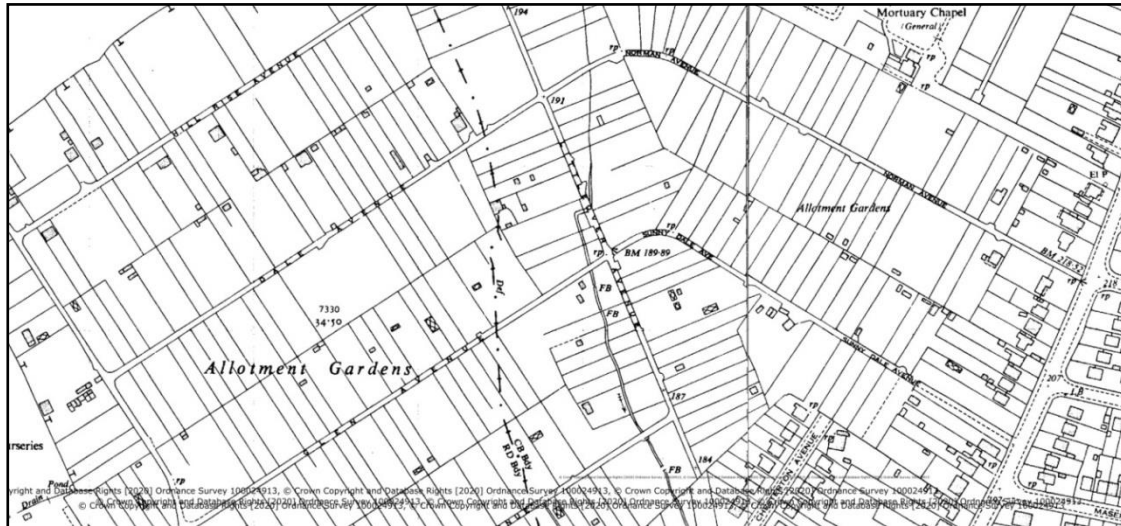

2020 Base Map

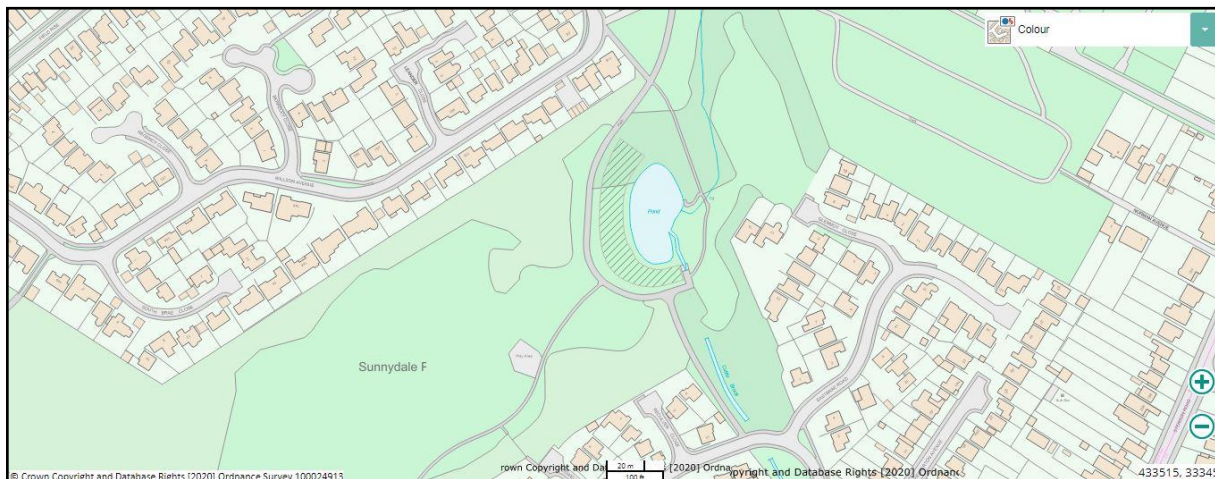

New allotment site: Craddock Avenue

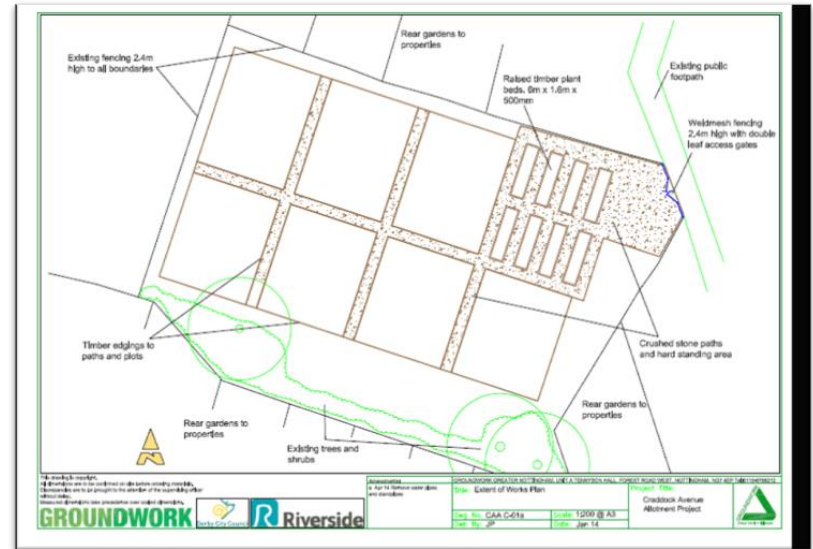

Self management model – benefits and risks

Benefits

- Community pride
- Autonomy (financial, rules, decision making)
- Flexibility/Ability to respond quickly
- Access to external funding/fund raising ability
- Volunteering/new skills/training opportunities
- Collaborative working with other organisations/businesses



Self management model – benefits and risks

Risks

- Variable volunteer skills/capabilities/experience
- High turn over of volunteers
- Not enough volunteers
- Inconsistent allotment management
- Liabilities for the allotment associations/trustees



Collaborative working and support for allotments

Local authority and allotment associations

- Officer support/building trust
- Signposting
- Derby Allotment Network Forum

Allotment associations and other organisations

- Community Action Derby
- Local media
- Local businesses



Thank you



Derby City Council