

Green infrastructure: Protecting the natural world and taking action for wildlife



Lancashire,
Manchester &
N Merseyside



© www.webbaviation.co.uk

By Tony Da Silva

Protecting Wildlife for the Future

The Lancashire Wildlife Trust is a registered charity (No. 229325) and a registered company (No. 731548)

Be part of it →



Lancashirewildlifetrust
@lancswildlife

Story So Far



Lancashire,
Manchester &
N Merseyside

- Set up in 1962, Approach to conservation has moved with the times
- Landscape Scale approach (based on Lawton Principles)
- Restoring landscape connectivity
- Connecting People and Wildlife
- Addressing the climate and ecological crisis through the management of good quality natural environments

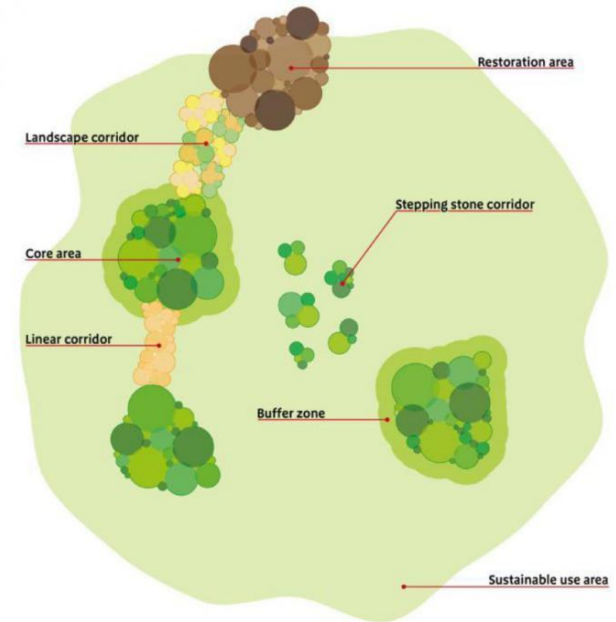

Protecting Wildlife for the Future

The Lancashire Wildlife Trust is a registered charity (No. 229325) and a registered company (No. 731548)

Be part of it



Lancashirewildlifetrust
@lancswildlife

Habitats

- Woodlands
- Grasslands
- Heathlands
- Peatlands
- Saltmarsh
- Coastal
- Urban



Protecting Wildlife for the Future

The Lancashire Wildlife Trust is a registered charity (No. 229325) and a registered company (No. 731548)

Be part of it



People



Lancashire,
Manchester &
N Merseyside

- Community engagement
- Events
- Volunteering
- Encourage local exploration
- Provide quality environments
- Raise awareness



Protecting Wildlife for the Future

The Lancashire Wildlife Trust is a registered charity (No. 229325) and a registered company (No. 731548)

Be part of it →



Lancashirewildlifetrust
@lancswildlife

Campaigns



Lancashire,
Manchester &
N Merseyside

- Environmental protection after Brexit
- Species
- Habitats
- Wild Places
- How we use our land
- Nature Recovery Network



Protecting Wildlife for the Future

Be part of it



Projects



Lancashire,
Manchester &
N Merseyside

- Peatland Initiative
- Great Manchester Wetlands
- Carbon Landscape
- My Wild City



Protecting Wildlife for the Future

Be part of it



Lancashirewildlifetrust
@lancswildlife

Case Study – Little Woolden Moss



Lancashire,
Manchester &
N Merseyside

- Acquired in 2012
- Peat extraction comes to an end
- Rewetting begins
- Carbon storage
- Reintroduction of mossland species
- Local community and volunteers



Protecting Wildlife for the Future

The Lancashire Wildlife Trust is a registered charity (No. 229325) and a registered company (No. 731548)

Be part of it →



Lancashirewildlifetrust
@lancswildlife

Why Restore Peatlands?



Lancashire,
Manchester &
N Merseyside

Why should
we restore our
peatlands?



Case Study – Fenscape



Lancashire,
Manchester &
N Merseyside

- Part of the Carbon Landscape
- Connecting fragmented wetlands of Wigan and Leigh
- Fen and ditch restoration and creation
- Carbon store
- Flood alleviation
- Wildlife benefits
- Recreational benefits
- Spiritual benefits



Protecting Wildlife for the future

Be part of it

 
Lancashirewildlifetrust
@lancswildlife

Investment



Lancashire,
Manchester &
N Merseyside

- Carbon Compensation Scheme
- Net Gain
- Great Crested Newt District Level Licencing
- Carbon Credits
- Habitat Banking
- Environmental Land Management Scheme



Eco Speed on Little Wooden

Protecting Wildlife for the Future

The Lancashire Wildlife Trust is a registered charity (No. 229325) and a registered company (No. 731548)

Be part of it



Lancashirewildlifetrust
@lancswildlife

Future



Lancashire,
Manchester &
N Merseyside

- Greater Manchester Environment Fund Pilot
- ELMS pilot
- First urban National Nature Reserve
- Provide Quality environments
- Nature Recovery Network
- Eco Tourism

